

# XSBWR08

**Function:**

Guiding elements are designed to prevent metal to metal contact between components of hydraulic systems e.g. piston and cylinder barrel or shaft and cylinder head.

**Features:**

- Normally cut at an angle for easy installation, but also available as non-split version.
- For use in rod applications.
- Integrated collar on outside diameter.
- Design combines guiding and backing function.
- Low dynamic friction.
- Low break-away forces after long standstills.

**Application:**

Reciprocating pistons and rods in hydraulic cylinders, plungers.

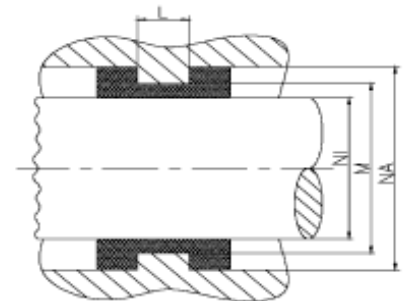
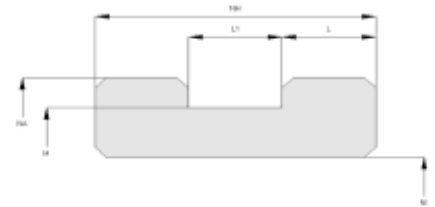

**Seal housing recommendation:**

Tolerances	[mm]	
Ø NA	H9	
Ø NI	h8	
Ø M	H9	

Surface roughness	Rtmax [µ]	Ra [µ]
Bottom of groove	≤ 6.3	≤ 1.6
Face of groove	≤ 15	≤ 3

Sliding surface	Rtmax [µ]	Ra [µ]
PU, elastomeres	≤ 2.5	≤ 0.1 - 0.5
PTFE	≤ 2	≤ 0.05 - 0.3

**Installation:**

Snap-in installation